

PRODUCT NUMBER
SEE TABLE

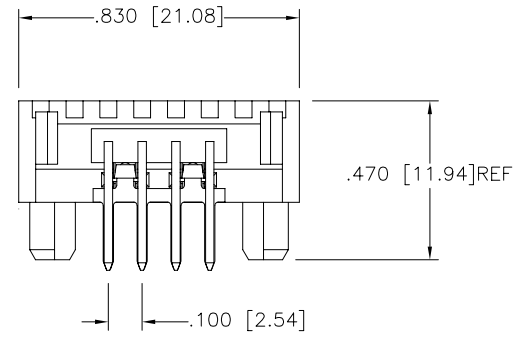
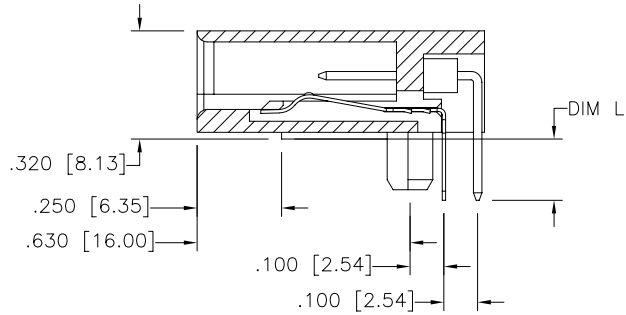
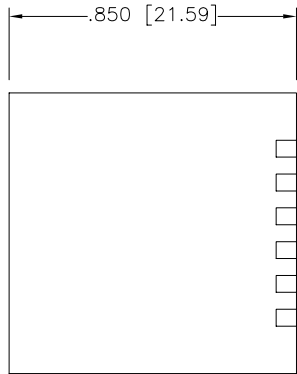

| | | | | | | | | | | | | |
|-------------|----------|-----|-----------------------|--------|----------------------------------|------------|---------------------------|--------|---------------------------------------|-------------------|-------|--|
| mat'l. code | | | surface ISO 1302 ✓ | | tolerance ISO 406 ISO 1101 | | projection FIRST ANGLE | | product family LATCH-N-LOK | | | |
| ltr | | | ecn no | | dr | | date | | tolerances unless otherwise specified | | title | |
| B | V00432 | TFG | 2/14/00 | angles | linear | .XX±.01/.3 | INCH/MM | | 1X4 LNL RT ANGLE HEADER ASSEMBLY | | | |
| C | V01795 | TFG | 9/11/00 | linear | .xxx±.005/.13 | scale 1:1 | | dwg no | | sheet 1 of 2 size | | |
| D | V10425 | TFG | 2/7/01 | 0°±2' | .xxx±.0020/.051 | FCJ | | 69273 | | A3 | | |
| E | M05-0033 | ERE | 2/25/05 | dr | J. LINN | 7/17/90 | type | | Product Customer Drawing | | | |
| F | M05-0052 | MHT | 3/16/05 | engr | D. HORCHLER | 7/17/90 | | | | | | |
| G | M06-0285 | AGS | 7/28/06 | chr | D. HORCHLER | 7/17/90 | | | | | | |
| H | M06-0365 | AGS | 9/20/06 | appd | D. HORCHLER | 7/17/90 | | | | | | |
| sheet | revision | H | H | | | | | | | | | |
| index | sheet | 1 | 2 | | | | | | | | | |

form: A3

69273-XXXXLF

LEAD FREE OPTION (6) (8)

| | COLOR (4) | |
|---|---------------------|-----|
| 1 | 70343 -LT- GRAY | OBS |
| 2 | 80166 OFF WHITE | |
| 3 | 70634 -DK- GRAY | OBS |
| 4 | 701 BLACK | |
| 5 | 70541 -SLATE- GRAY | OBS |
| 7 | 70455 SILVER GRAY | |
| 8 | 80189 -PEARL- WHITE | OBS |
| 9 | 70419 PEBBLE GRAY | |

| | PLATING (9) |
|---|----------------------|
| 0 | 30u" GXT |
| 3 | 30u" AU OVER 50u" NI |
| 5 | 50u" AU OVER 50u" NI |

| | PIN LENGTH |
|---|------------|
| | DIM L |
| 0 | .150/3.81 |
| 1 | .110/2.79 |

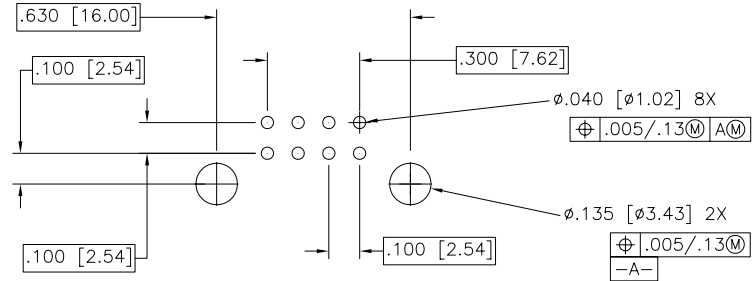

RECOMMENDED PCB LAYOUT

NOTES:

- HEADER SHROUD
MAT'L: POLYCARBONATE, 94 VO RATED.
- GROUND CONTACT
MAT'L: COPPER ALLOY
PLATING: 100-150u"/2.54-4.06u TIN.
- SIGNAL CONTACT
MAT'L: COPPER ALLOY
PLATING: SEE TABLE
- NUMBERS SHOWN ARE FOR G.E. LEXAN AND ARE FOR REFERENCE ONLY.
- THIS ASSEMBLY U.L. APPROVED PER FILE E66906 VOL. 1, SEC 84 AND CSA APPROVED PER MASTER FILE LR 46923
- ADD LF SUFFIX AT THE END OF PART NUMBER FOR LEAD FREE OPTION.
- THE HOUSING WILL WITHSTAND EXPOSURE TO 260°C PEAK TEMPERATURE FOR 15 SECONDS IN A WAVE SOLDER APPLICATION WITH A 1.5mm MINIMUM THICK CIRCUIT BOARD. SEE APPLICATION NOTES/PROCEDURES IF THEY ARE AVAILABLE.
- THIS PRODUCT MEETS EUROPEAN UNION DIRECTIVES AND OTHER COUNTRY REGULATION AS DESCRIBED IN GS-22-008.
- PLATING OPTIONS:
MAY BE EITHER GOLD OR GXT PLATED AT MANUFACTURER'S OPTION.

| | | | | | |
|-------------|----------------|-----------------------|----------------------------------|-----------------|---|
| mat'l. code | | surface ISO 1302 ✓ | tolerance ISO 406 ISO 1101 | projection ⊕ | product family LATCH-N-LOK |
| ltr | ecn | no | dr | date | tolerances unless otherwise specified |
| H | | | | | angles linear |
| | | | | | .XX±.01/.3 .xxx±.005/.13 .xxxx±.0020/.051 |
| | | | | | 0'±2' |
| | | | | | dr J. LINN 7/17/90 |
| | | | | | enr D. HORCHLER 7/17/90 |
| | | | | | chr D. HORCHLER 7/17/90 |
| | | | | | app D. HORCHLER 7/17/90 |
| sheet index | revision sheet | | | | |

| | |
|-------------------------------|----------------------------------|
| title | 1X4 LNL RT ANGLE HEADER ASSEMBLY |
| dwg no | 69273 |
| sheet 2 of 2 | size A3 |
| type Product Customer Drawing | |



Copyright FCI